

## Liquid Tight Plugs

Offers protection to IP67

### Features

Easy to install with just finger pressure.

Part Number	Mounting Hole	A	B	C	Max. Panel Thickness
22-LTP13	12.7	23.4	11.4	7.3	3.2
22-LTP16	15.88	27.6	11.3	8.1	3.2
22-LTP19	19.1	29.2	13	8.9	3.2
22-LTP22	22.23	32	12.7	9.5	3.2
22-LTP25	25.4	35.8	14.2	10.1	3.2

Material: Black UL94 V0 Silicone Rubber

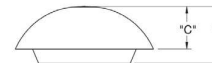
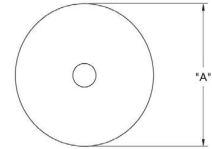

## Two Piece Grommet

Male and Female parts for easy hand assembly – press together • Recommended hole size 7/16" or 11.1mm

Used for reinforcing through holes and attaching samples of paper and cloth.

Part Number	Panel Hole Diameter	Overall Diameter	Through Hole
22-PTG11F	11.1	17.45	-
22-PTG11M	11.1	17.46	6.35

For panel thickness 0.8 and 1.6mm



## Stepped Grommet

Stepped Sleeve can be cut to requirements

• Suit a range of cable diameters

Protect cables passing through panels.  
Act as blanking plug until cut.

Part Number	Panel Hole Size D mm	Panel/Sheet Thickness T mm	Cable Range mm	Length H mm
22-SG21-NEW	21	3	5-17	27.5

Material: Black PVC

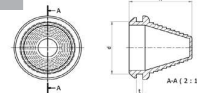

## Rubber Strain Relief Bush

Insulation and strain relief for small cables

Part Number	Panel Hole Diameter	Max. Cable Diameter A	Max. Panel Thickness
22-LGT4024	4.0	2.3	2.4
22-LGT4824	4.8	3.0	2.4

Material: Black T.P.E

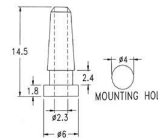

## Lamp Snap Bushes

Protection of lampcord insulation from sharp edges of threaded pipe

Part Number	Inside Diameter G	Outside Diameter A	Overall Length L	Max Sleeve OD	Flange Thickness
03-LSB0125	5.8	9.5	6.3	7.6	0.8

Material: Black high density Polyethylene

