

## 4122 - Male / Female Anti-Vibration Mount

Rubber & Zinc Plated Steel

Part Number	D	h	E	d	s	Cp	Cz
11-AVMF1515S4	15	15	14	M4	1.5	20	4
11-AVMF2015S6	20	15	15	M6	1.5	50	4
11-AVMF2020S6	20	20	15	M6	1.5	40	3
11-AVMF2520S6	25	20	18	M6	2	60	6
11-AVMF2530S6	25	30	18	M6	2	40	4
11-AVMF3020S8	30	20	23	M8	2	90	10
11-AVMF3030S8	30	30	23	M8	2	80	8
11-AVMF3038S8	30	38	23	M8	2	65	6
11-AVMF4030S8	40	30	23	M8	2	120	16
11-AVMF4035S8	40	35	23	M8	2	100	14
11-AVMF5020S10	50	20	27	M10	3	220	22
11-AVMF5030S10	50	30	27	M10	3	200	20
11-AVMF5040S10	50	40	27	M10	3	170	18
11-AVMF5050S10	50	50	27	M10	3	150	14
11-AVMF6550S12-37	65	50	37	M12	2	350	30
11-AVMF7525S12	75	25	37	M12	3	500	90
11-AVMF7540S12	75	40	37	M12	3	490	80
11-AVMF7550S12	75	50	37	M12	3	480	70
11-AVMF10050S16	100	50	46	M16	3	850	100
11-AVMF10055S16	100	55	46	M16	4	800	80
11-AVMF10060S16	100	60	46	M16	4	700	50

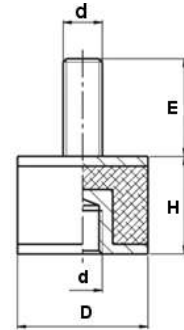

\* Cp Maximum load compression (kg)  
\* Cz Maximum load shear (Kg)

## 4123 - Female / Female Anti-Vibration Mount

Rubber & Zinc Plated Steel

Part Number	D	h	d	s	Cp	Cz
11-AVFF1515S4	15	15	M4	1.5	20	4
11-AVFF2020S6	20	20	M6	1.5	40	3
11-AVFF2520S6	25	20	M6	2	60	6
11-AVFF2530S6	25	30	M6	2	40	4
11-AVFF3020S8	30	20	M8	2	90	10
11-AVFF3030S8	30	30	M8	2	80	8
11-AVFF3038S8	30	38	M8	2	65	6
11-AVFF4030S8	40	30	M8	2	120	16
11-AVFF4035S8	40	35	M8	2	100	14
11-AVFF5030S10	50	30	M10	3	200	20
11-AVFF5040S10	50	40	M10	3	170	18
11-AVFF5050S10	50	50	M10	3	150	14
11-AVFF6050S10	60	50	M10	2	350	30
11-AVFF7525S12	75	25	M12	3	500	90
11-AVFF7540S12	75	40	M12	3	490	80
11-AVFF7550S12	75	50	M12	3	480	70
11-AVFF10050S16	100	50	M16	3	850	100
11-AVFF10055S16	100	55	M16	4	800	80
11-AVFF10060S16	100	60	M16	4	700	50

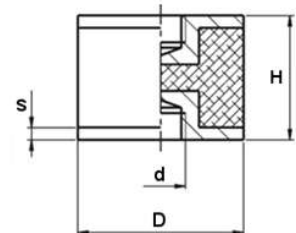

\* Cp Maximum load compression (kg)  
\* Cz Maximum load shear (Kg)